

Motorized Sweeper

GS70100



Operation Manual



Contents

1.	P r e p a r a t i o n	1
2.	I n s t a l l a t i o n	5
3.	O p e r a t i o n a n d R e g u l a t i o n	5
4.	M a i n t e n a n c e	8
5.	Q u a l i t y A s s u r a n c e	9
6.	K e y T e c h n i c a l P a r a m e t e r s	1 1



*** Description ***

Thank you for using our products. We hope you will spend many enjoyable hours using it. Please read through these instructions carefully. Learn all the controls and the correct use of the machine.

1. Preparation

1.1 Purpose and Features

This sweeper is designed and built to sweep yards, roads, lanes and storehouses.

This sweeper is self-propelled which is working highly efficient and help the user save time and power. This unit is well designed, has excellent ergonomics, simple and convenient adjustment, and is comfortable to use during operation.

Declaration:

- A. The sweeper must only be used with original equipment and spares. Any use other than those here described is prohibited and will involve, in addition to cancellation of the warranty, serious risk for the operator and bystanders.**
- B. This company does not take any responsibility for the consequences arising from misuse of this unit.**
- C. This company will not be responsible for any bodily injury or property loss on any third party arising from improper use of this unit.**
- D. Must abide by the relevant regulations of your country when operate this machine.**

1.2 Introduction of the Main Parts:



- 1. Travel clutch lever**
- 3. Sweep clutch lever**
- 5. Brush steering lever**

- 2. Sweep speed adjust lever**
- 4. Travel speed adjust lever**
- 6. Brush height adjust lever**

1.3 Safety Instruction



Before assembly and putting the machine into operation, please read carefully the operating instructions:

1. Be thoroughly familiar with the controls and the proper use of the equipment. Know how to stop the unit and disengage the control quickly.
2. Never allow children to operate the equipment. Never allow adults to operate the equipment without proper instruction.
3. Incorrect operation may result in bodily injury and damage to machine.
4. Never use the machine if others, particularly children or pets are in the vicinity.
5. Do not run when pushing this unit, but walk at a normal speed while operating this machine.
6. Keep your body and clothes away from the heating or rotating parts of this unit. No loose clothes, neckties and necklaces are allowed when you operate this unit.
7. Inspect the working area of this unit completely and remove all obstacles.
8. Do not use this unit on a bumpy or steep road. Exercise caution to avoid slipping or falling, especially when operating in reverse.
9. Take care in operation, especially when crossing a road, to prevent accidents.
10. Inspect that all nuts, bolts and brush rollers are tight and well connected to ensure the safety and reliability of this unit prior to any operation.
11. Adjust the clutch pull cable to ensure it is flexible and reliable.
12. Adjust the brush to proper height prior to any operation.
13. If the unit strikes a foreign object or starts to vibrate abnormally, stop the engine and check immediately for the cause (this is very important!)
14. Stop the engine and pull out the spark plug whenever you leave the operating position, before making any repairs, adjustments, inspections or approaching running parts.
15. Inspect the air pressure in the tires prior to use and pay attention to sharp objects when using this unit to prevent the tire from being pierced.
16. Replace worn components for safety reasons prior to use.
17. Take care during the adjustment or maintenance of this unit to prevent any injury to your fingers.
18. Don't operate this machine without essential safety equipment (blinkers, earplug and dust proof mask, etc.).
19. Inspect the fuel container before operating the equipment; the fuel container must be full.
20. Handle fuel with care: it is highly flammable.
 - A) Use the approved fuel.
 - B) Never add fuel to a running or hot engine.
 - C) Only fill or top up with fuel outdoors. Never fill fuel indoors. Keep away from any fire source.
 - D) Screw the filler cap on tightly and wipe up spilt petrol.
 - E) Move this machine at least 3m away from the refueling point before starting engine.
 - F) Always store gasoline in a container approved for containing flammable liquids.
21. To reduce the risk of injury associated with exhaust fume inhalation, do not operate in unventilated area.
22. Except as provided for in the manufacturer's statement, no adjustment shall be done while the engine is running.
23. Since some parts of this unit are made of plastic or rubber materials, it should be kept away from any chemical articles, to prevent a chemical reaction from occurring.

24. Operate this unit at suitable hours, not early in the morning or late at night, when people might be disturbed. Comply with times listed in local ordinances.
25. Limit the number of piece of equipment used at any one time.
26. If use the machine at night, please check if the illumination system is in good condition first.
27. Check the power line and socket before using this device and make sure it can work properly.
28. Don't use this device in the rain.

2. Assembly

2.1. Unpack the package and check against the assembly diagram. In case of any missing, contact the dealer for makeup (see Figure 1).

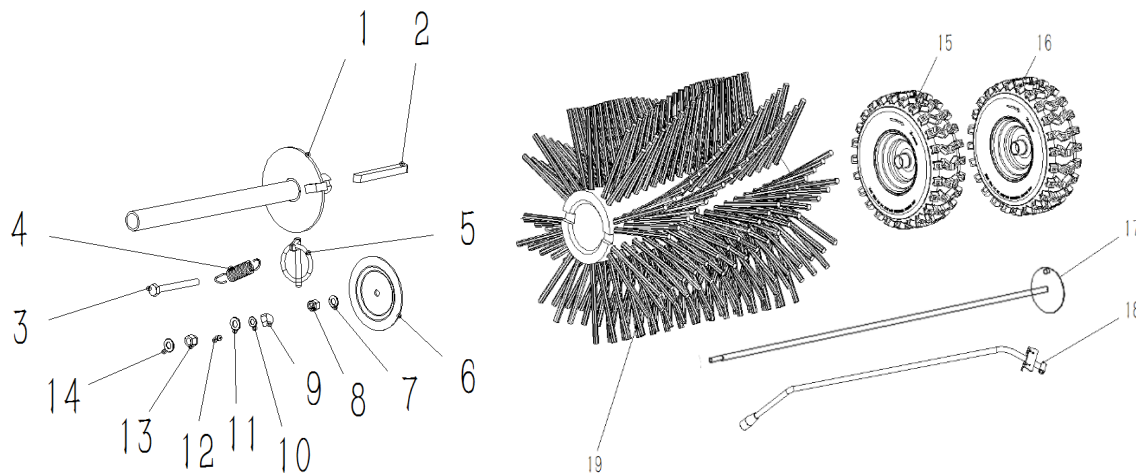

Figure 1

- | | | |
|--|---|------------------------|
| 1. Column brush link (2) | 2. Flat key 8x7x80 (1) | 3. Hex bolt M8x70 (1) |
| 4. Armrest adjusting tension spring (2) | 5. Spring pin assembly (2) | 6. Fixing plate (1) |
| 7. Flat washer $\Phi 12 \times \Phi 24 \times 2$ (1) | 8. Hex nut M12 (1) | 9. Cap nut M10 (4) |
| 10. Spring washer $\Phi 10$ (4) | 11. Flat gasket $\Phi 10 \times \Phi 20 \times 1.5$ (4) | |
| 12. Cross recessed flat-head screw M6x12 (2) | 13. Hex lock nut M8 (1) | |
| 14. Flat gasket $\Phi 8 \times \Phi 16 \times 1.2$ (2) | 15. Right wheel (1) | 16. Left wheel (1) |
| 17. Brush drawbar (1) | 18. Brush steering lever (1) | 19. Sweeping brush (2) |

2.2 Install the Tyre: As shown in the figure, pass the wheel (2) onto the wheel shaft (3) and insert the spring pin (1) into the hole of the wheel shaft (3). Install the left (or right) wheel in the same way and pay attention to the direction indicated by the arrow sign on the tyre. (See Figure 2)

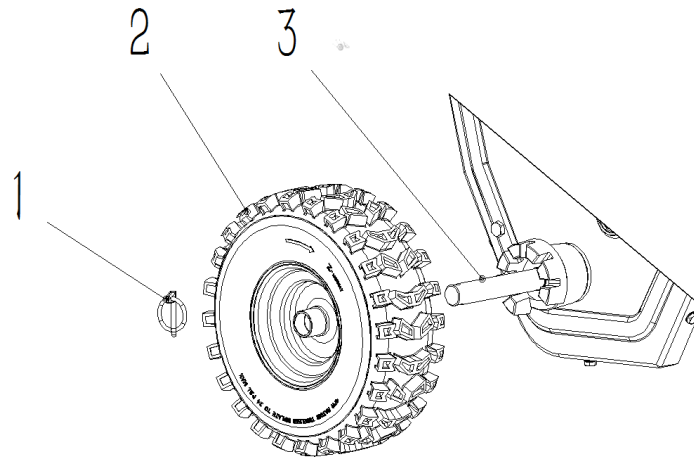

Figure 2

2.3 Install the Sweeping Brush: Fit the flat key 8x7x80 (2) into the keyway of the worm gear box (3); align the column brush link (1) to the flat key and then install it into the worm gear box (3); mount the sweeping brush (4) onto the column brush link (1); pull the sweeping brush drawbar (8) into the inner hole of the column brush link (1); pad both sides of the sweeping brush (4) with fixing plate (7) and flat gaskets $\Phi 12 \times \Phi 24 \times 2$ (6), respectively; and tighten up with hex lock nuts M12 (5). (See Figure 3)

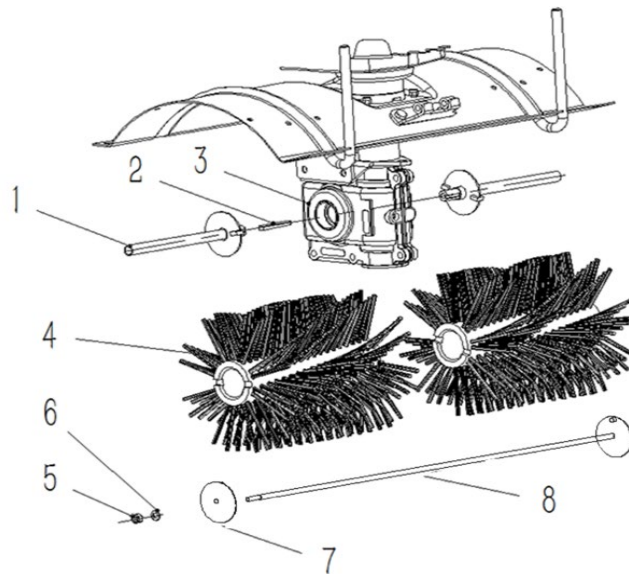

Figure 3

2.4 Install the Armrest: Locate the armrest (1) onto four welded bolts (5) and tighten up with flat gaskets $\Phi 10 \times \Phi 20 \times 1.5$ (4), spring washers $\Phi 10$ (3), and cap nuts M10 (2). (See Figure 4)

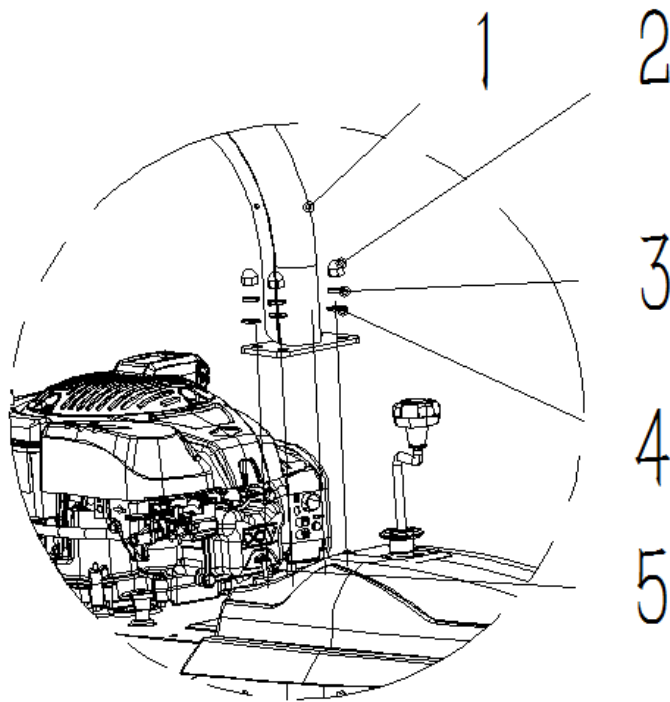

Figure 4

2.5 Install the Brush Steering Lever: Align the upper tube of the steering lever (2) to the tube on the hinge seat, pass hex bolt M8x70 (7) into the tube, place the flat gasket $\Phi 8 \times \Phi 16 \times 1.2$ (5), and tighten up with hex lock nut M8 (4). Use one end of the armrest adjusting tension spring (1) to cover the main baffle screw and the other end to hook inside the hole of the steering lever, align the rubber piece (6) to two holes on the steering lever, and fix the rubber piece with cross-recessed flat head screw M6x12 (3). (See Figure 5)

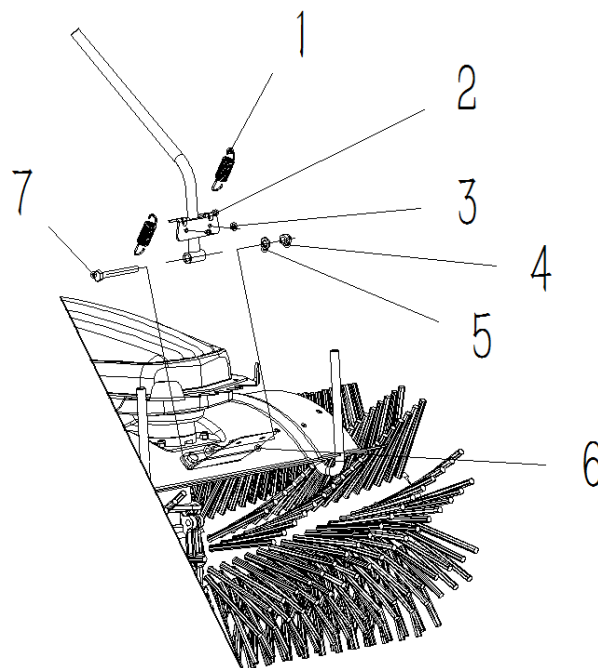

Figure 5

3. Operation and Adjustment



Warning: before using this unit, read through the safety instructions in the first part!

3.1 How to start the engine

1. Turn the switch to “ON”.
2. Open the choke and accelerator, and then pull the starter cord to start it.
3. Plug the power cable into the wall socket.
4. Don't push the electric button until you are sure that the power line is properly connected with the power source.
5. Get the plug out and close the cover when the engine is started; then close the choke.

3.2 Turn off the engine

Turn the switch of engine to “OFF” and the engine will turn off.

3.3 Lever clutching

1. Travel Clutching: The travel clutch lever of the machine is used to control the travel driving wheel.
 - A. In the released state, the movement of the machine is turned off;
 - B. When pressed downwards, the movement of the machine is turned on. (The forward speed can be changed by the user by selecting different speed positions).
2. Sweep Clutch Lever Operation: The sweep clutch lever of the machine is used to control the sweeping brush.
 - A. In the released state, the sweeping action is deactivated;
 - B. When pressed downwards, the machine starts sweeping.

Clutch Lever



Sweep Clutch Lever

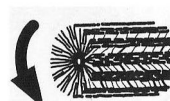

3.4 Travel Speed Selection

There are five forward speeds which can be selected by adjusting the travel speed adjust lever. It is recommended to use Forward Speed 1 or 2 for travel with sweeping operation and Forward Speed 3, 4, or 5 for travel without sweeping operation.

3.5 Sweeping Speed Selection

There are six sweeping speeds which can be selected by adjusting the sweep speed adjust lever.

3.6 Operation of support wheel

The support wheel plays a role of supporting and turning the unit, and also for adjusting the height of the brush.

- A. Increase the height of the brush by rotating the rider of the support wheel clockwise.
- B. Decrease the height of the brush by rotating the rider of the support wheel counterclockwise.

3.7 Brush direction adjustment

Press downwards the brush steering lever and move it to the left or right until it is well seated in the slot. Then the brush's direction can be adjusted.

3.7 Machine storage

Drain the gasoline from the machine in seasons it is not used. Store the machine indoors when the temperature is below -10°C. Replace the engine oil and clean the air filter regularly

4. Maintenance

Storage after use:

1. Clear off dirt from the unit.
2. Never place a unit with a gasoline engine in the room. If necessary, keep it away from fire sources.
3. Never put this unit in a high temperature environment or in direct sunlight, because some parts are made of plastic or rubber materials and may be damaged.

The unit shall be stored if it is out of service for a long period of time.

1. Wash and clean the unit.
2. Place it in a dry and well-ventilated room.
3. The unit shall be placed in the normal working state for the convenience of use.

Notice: the following maintenance shall be implemented on schedule for long term reliable service:

- Regularly inspect for any obvious defects, i.e. the brush is loose, misaligned or damaged, fasteners are loose or elements are damaged.
- Inspect if the rider is damaged or misaligned. Necessary maintenance shall be implemented prior to use.
- Any failure to work due to manufacturing or testing shall be maintained and repaired by professional customer service agencies.
- This operation manual is prepared based on the latest type of this unit. The manufacturer reserves the right to modify it without notice.

5. Warranty

The importers of this company shall determine the quality warranty. Within the quality warranty, free maintenance for your product due to any cause or reasons arising from the materials and the unit shall be available. If you want to repair your unit, please contact the distributor or local agency.

If there are any problems with your product, the following troubleshooting may help solve the problem. For any further questions, please contact the distributor.

6 Troubleshooting

Fault	Possible cause	Corrective actions
Engine does not start	Consult engine manual	Consult engine manual
Engine runs unevenly(stutters)	Consult engine manual	Consult engine manual
Machine does not sweep	V-belt slack or torn	Have slack V-belt tightened. Have torn V-belt replaced.
Machine does not drive along	Coupling cable for drive system not adjusted correctly	Adjust coupling cable
	V-belt slack or torn	Have slack V-belt tightened. Have torn V-belt replaced.
	Friction-wheel rubber torn	Have friction-wheel rubber replaced
Excessive vibration	Loose parts or damaged worn	Stop engine, immediately and pull off spark-plug connector. Tighten loose bolts and nuts. Have damaged worm repaired.
Gears can only be changed with difficulty	Coupling cable for drive system not adjusted correctly	Adjust coupling cable
	Shift lever not correctly adjusted	Adjust shift lever