

# 74<sup>PC</sup> DOUBLE SIDED WHEELED BIN STORAGE

## User Guide

The Wheeled Bin Storage is designed and intended for domestic use only. It should not be used for commercial purposes. This unit is not a toy. Children should supervised to ensure they do not play with the Wheeled Bin Storage. This unit contains small parts and components which pose a choking hazard to children and animals. Keep these parts away from children and pets.

Check the contents of the packaging against this User Guide to ensure there are no missing or defective parts. Never use defective parts.

Assemble only as instructed within this user guide. Any deviation or shortcut may lead to incorrect assembly or be considered customer misuse. Improper assembly may cause damage or serious injury.

Do not mount the Wheeled Bin Storage to a vehicle.

Do not overtighten any parts during assembly as this will damage the unit.

**WARNING!** The Wheeled Bin Storage should only be positioned on a flat stable surface.

Do not overload the Bins. For stability, heavier items should always be placed in the bottom Bins.

Do not rest or support items against or on the Wheeled Bin Storage.

**CAUTION:** To ensure continued safety, check the unit is secure and safe to use at regular intervals (every 3 months). Take appropriate action to rectify any unstable or unsafe units.

If you do not understand these directions, or have any doubts regarding the safety of the assembly, please seek advice and guidance from a qualified person.

Appropriate safety gear must be worn and precautions taken when installing this product.

We recommend that two people are present to install this Wheeled Bin Storage.

**WARNING!** Do not exceed the maximum stated load capacity recommended as this may result in damage or serious injury.

### WEIGHT CAPACITY

Small Bins - 1.5Kg (each)  
Large Bins - 2.3.kg (each)  
Top Tray 10Kg  
Bottom Tray 25Kg  
Overall Capacity - 154Kg

### CLEANING & CARE

To clean the Wheeled Bin Storage, use and a damp cloth. Avoid using any harsh or abrasive chemicals as this can damage the finish.

### CONTENTS

- |                            |                               |
|----------------------------|-------------------------------|
| 1. Column x2               | 11. M4x9 Screw x30            |
| 2. Hanging Bars x10        | 12. M6x10 Screw x26           |
| 3. Hanging Bar Supports x6 | 13. M6x35 Screw x4            |
| 4. Top Tray                | 14. M6 Nut x28                |
| 5. Bottom Tray             | 15. M6x15 Screw x2            |
| 6. Column Supports x4      | 16. Small Bin (not shown) x64 |
| 7. Caster with Brake x2    | 17. Large Bin (not shown) x10 |
| 8. Caster Without Brake x2 |                               |
| 9. Handle                  |                               |
| 10. Handle Bracket x2      |                               |

# ASSEMBLY

**1.** Attach both Casters with Brake (**7**) to the flat, bottom of the Bottom Tray (**5**). Attach both Casters with Brake along the same end as shown. Secure each Caster with Brake in place with four Screws (**12**) and Nuts (**14**). Repeat this step for the Casters Without Brake (**8**).

**2.** Attach Hanging Bars (**2**) to each Column (**1**). Secure the Hanging Bars in place by snapping into place on each side of the Hanging Bar tabs on each column.

**3.** Attach the Hanging Bar Supports (**3**) to the ten Hanging Bars. Secure in place with Screws (**11**).

**Note:** Check that all Hanging Bar holes are aligned before attaching Hanging Bar Supports.

**4.** Attach both columns to Bottom Tray (**5**). Secure in place with Screws (**13**) and Nuts (**14**).

**5.** Attach the ends of two Column Supports (**6**) placed together to the bottom of each Column with one Screw (**15**) per column. Attach the other ends of the Column Supports to the Bottom Tray with Screws (**12**) and Nuts (**14**).

**6.** Secure Top Tray (**4**) to the Top Tray tabs at the top of both Columns with Screws (**12**) and Nuts (**14**).

**7.** Attach lower Handle Bracket (**10**) to Column. Secure with a Screw (**12**). Hold Handle (**9**) onto attached Bracket, and then attach other Handle Bracket to Column to secure Handle in place.

**8.** Arrange Bins as desired. Slide Bin lip over Hanging Bar, making certain Bin is securely in place.

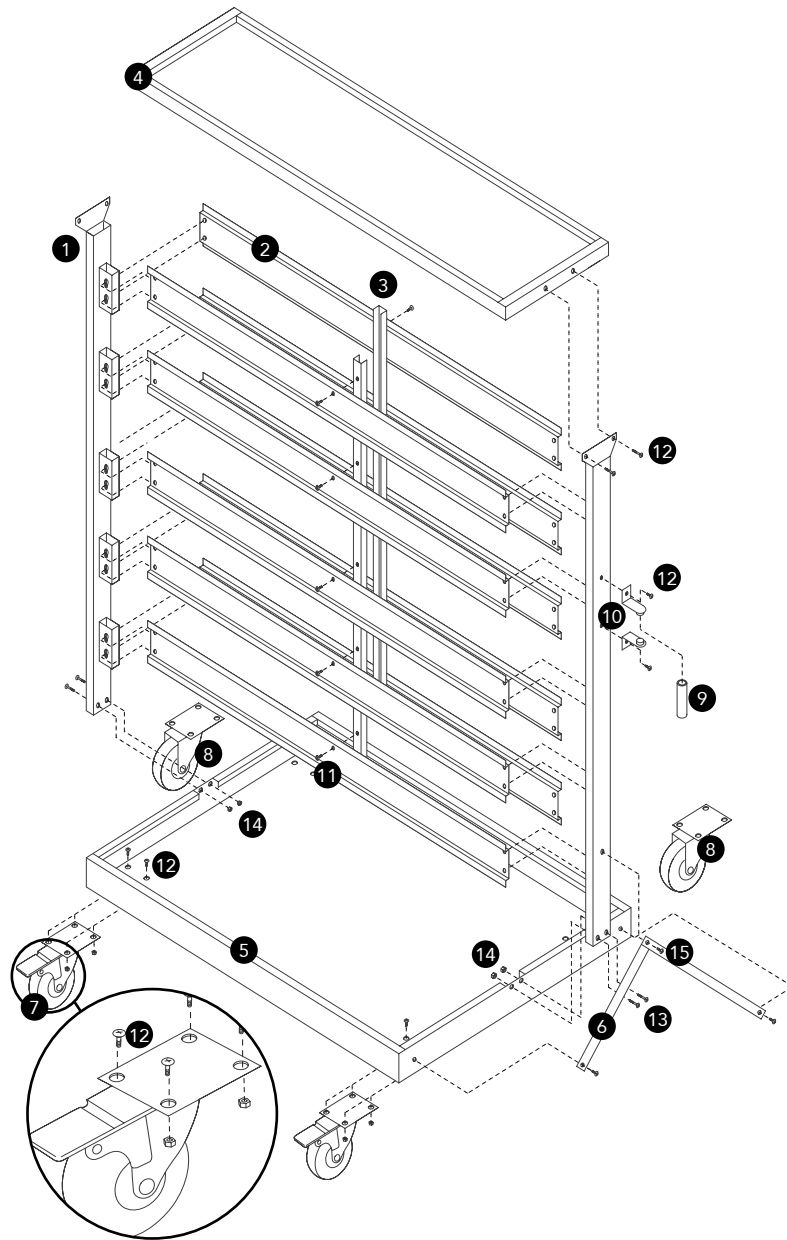

## DISPOSAL INFORMATION

Please recycle where facilities exist. Check with your local authority for recycling advice.