

Popcorn Machine Cart

ET-POP6C

User Manual

Read clearly before using

Popcorn machine cart is one equipment which helps popcorn machine body locating and moving. It has the features of easy operation and practicality, it can also being torn down when packing.

I, MACHINE STRUCTURE(SEE CHART DETAILS)

II, ASSEMBLE STEPS.

- 1, Overturn the cart body, and fit the short leg to the body.
- 2, Fit the wheel to axes, then fasten to the short leg.
- 3, Fit the moving wheel to long leg, then fasten to cart body.
- 4, Overturn the cart body back normal, then fit the handle.
- 5, Add the platform at last.

III, OPERATION

Put the popcorn machine on the cart, then you can move the cart anywhere you want, when the cart stop moving, press down the brake on the moving wheel with feet, this is help the cart stand steady. When you want to move the cart, just loose the brake is ok.

IV, CLEANING AND MAINTAINCE

1. Pls clean the cart every some time with water and detergent.
2. Add some lube such as butter to cart axes and parts of moving when when it can't move easily.

ASSEMBLING CHART

Please assemble the cart as follow steps.

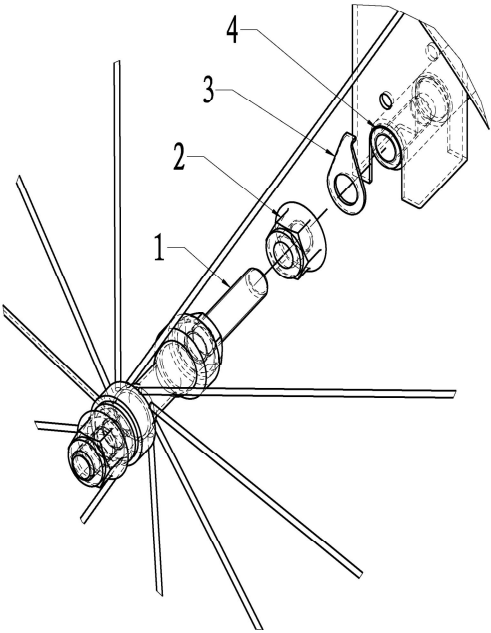
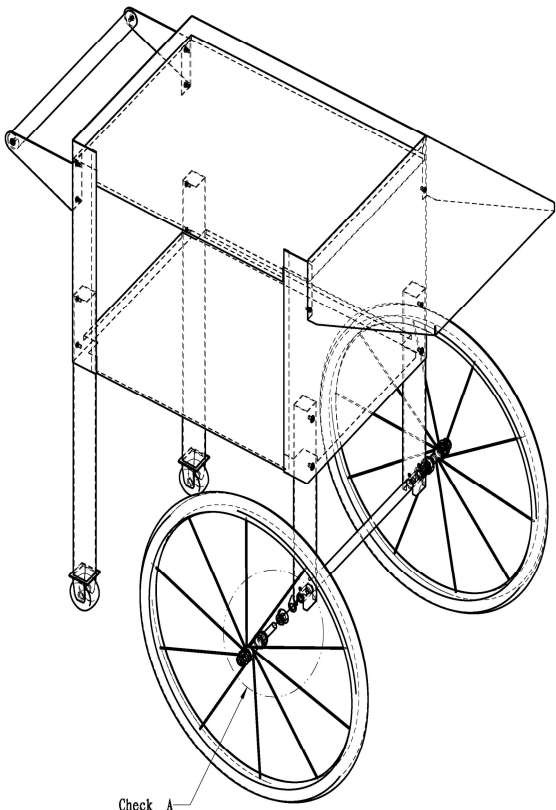

Detail A
Proportion 1:1